

**PURIQUE**

Sanitary Ware

**Product**

---

Catalogue





# Contents

---

<b>Basin</b>	1 - 8	<b>Squatting Pan</b>	21
<ul style="list-style-type: none"><li>• Counter Top</li><li>• Undercounter</li><li>• Wall Hung</li><li>• Pedestal</li><li>• Vessel</li></ul>			
<b>Bathtub</b>	9 - 10	<b>Cleaner Sink</b>	22
		<ul style="list-style-type: none"><li>• Wall Hung</li><li>• Pedestal</li></ul>	
<b>Shower Tray</b>	11 -12	<b>Baby Changing Station</b>	23 - 24
		<ul style="list-style-type: none"><li>• Vertical</li><li>• Horizontal</li><li>• Baby Seat</li></ul>	
<b>Water Closet (WC)</b>	13 - 17	<b>Accessories</b>	25 - 31
<ul style="list-style-type: none"><li>• One-piece</li><li>• Close coupled</li><li>• Back-to-wall</li><li>• Wall Hung</li></ul>		<ul style="list-style-type: none"><li>• Grab Bar</li><li>• Mirror</li><li>• Shower Seat</li><li>• Shower Curtain Rail</li><li>• Paper Dispenser</li><li>• Paper Holder</li><li>• Soap Dispenser</li><li>• Hand Dryer</li><li>• Towel Rack</li><li>• Robe Hook</li><li>• Brush Holder</li><li>• Soap Basket</li></ul>	
<b>Seat and Cover</b>	18		
<ul style="list-style-type: none"><li>• Intelligentize</li></ul>			
<b>Bidet</b>	19		
<b>Urinal</b>	20		
<ul style="list-style-type: none"><li>• Wall Hung</li><li>• Floor Stand</li></ul>			

# Basin



The images above are for reference only. The real object should be considered as final.

# Basin

## Counter Top

---



**LG2-001**

RTM round shaped resin compound counter top basin with overflow hole.  
Rim thickness: 30mm  
Material: Resin Transfer Moulding  
Size: 460 x 165 dia. mm



**LG2-002**

BMC high pressure moulding Rectangular shaped counter top wash basin without overflow hole.  
Rim Thickness: 4mm  
Material: Bulk Moulding Compound  
Size: 590 x 310 x 130 mm



**LG2-003**

BMC high pressure moulding Rectangular shaped counter top wash basin without overflow hole.  
Rim Thickness: 4mm  
Material: Bulk Moulding Compound  
Size: 460 x 352 x 145 mm



**LG2-004**

BMC high pressure moulding Rectangular shaped counter top wash basin without overflow hole.  
Rim Thickness: 4mm  
Material: Bulk Moulding Compound  
Size: 600 x 380 x 120 mm



**SX2-010**

Counter-top basin  
Size: 500 x 380 x 155 mm

The images above are for reference only. The real object should be considered as final.

# Basin

## Undercounter

---



### LG2-006

RTM One piece long rectangular top with 2 Oval shaped undercounter type wash basin with overflow hole.

Rim Thickness: 8mm

Material: Bulk Moulding Compound

Size: 1900 x 600 x 320 mm

### LG2-007

RTM One piece long rectangular top with rectangular shaped undercounter type wash basin with overflow hole.

Rim Thickness: 8mm

Material: Resin Transfer Moulding

Size: 1600 x 630 x 270 mm



### SX2-004

Undercounter basin  
Size: 560 x 430 x 190 mm



### SX2-005

Undercounter basin  
Size: 465 x 375 x 195 mm



### SX2-006

Undercounter basin  
Size: 495 x 410 x 200 mm



### ST2-005

Undercounter basin  
Size: 525 x 345 x 180 mm

The images above are for reference only. The real object should be considered as final.

# Basin

## Semi-counter

---



**SX2-001**

Semi-counter basin with wing  
Size: 810 x 460 x 180 mm



**SX2-007**

Semi-counter basin  
Size: 900 x 490 x 195 mm



**SX2-009**

Semi-counter basin  
Size: 505 x 450 x 185 mm



**SX2-015**

Semi-counter basin  
Size: 460 x 355 x 170 mm

The images above are for reference only. The real object should be considered as final.

# Basin

## Wall Hung

---



### **LG2-005**

BMC high pressure moulding  
Oval shaped wall hung type  
wash basin without overflow hole.  
Including of metal towel ring.  
Rim Thickness: 4mm  
Material: Bulk Moulding Compound  
Size: 700 x 360 x 150 mm



### **ST2-001**

Wall Hung basin with  
one central taphole & overflow hole  
Size: 500 x 410 x 195 mm



### **ST2-002**

Wall Hung basin with  
one central taphole & overflow hole  
Size: 380 x 310 x 150 mm



### **KN2-003**

Wall Hung basin  
Size: 360 x 260 x 120 mm



### **KN2-004**

Wall Hung basin with fixing  
Size: 440 x 270 x 150 mm

The images above are for reference only. The real object should be considered as final.



# Basin

## Wall Hung

---



### **KN2-005**

Wall Hung basin  
Size: 570 x 470 x 470 mm



### **ST2-006**

Wall Hung basin  
Size: 500 x 410 x 540 mm



### **ST2-007**

Wall Hung basin  
Size: 355 x 355 x 200 mm

## Pedestal

---



### **ST2-008**

Pedestal basin  
Size: 560 x 550 x 820 mm

The images above are for reference only. The real object should be considered as final.

# Basin

## Vessel

---



**ST2-004**

Vessel basin  
Size: 480 x 250 x 140 mm

The images above are for reference only. The real object should be considered as final.

# Basin

## Vessel

---



### KN2-006

Vessel basin  
Size: 650 x 430 x 170 mm



### KN2-007

Vessel basin  
Size: 650 x 410 x 135 mm



### KN2-008

Vessel basin  
Size: 590 x 400 x 160 mm



### SX2-008

Vessel basin  
Size: 455 x 410 x 185 mm



### SX2-011

Vessel basin  
Size: 480 x 370 x 130 mm



### SX2-012

Vessel basin  
Size: 430 x 430 x 120 mm



### SX2-013

Vessel basin  
Size: 500 x 390 x 130 mm



### SX2-014

Vessel basin  
Size: 490 x 380 x 130 mm

The images above are for reference only. The real object should be considered as final.

# Bathtub

---



## LG5-001

RTM Resin Compound Oval Shaped  
Free Standing Bathtub without built-in overflow hole.  
Rim Thickness: 8mm  
Material: Resin Transfer Moulding  
Size: 1700 x 830 x 590 mm



## LG5-002

RTM Resin Compound Oval Shaped  
Free Standing Bathtub with built-in overflow hole.  
Rim Thickness: 30mm  
Material: Resin Transfer Moulding  
Size: 1700 x 800 x 580 mm



## LG5-003

RTM Resin Compound Oval Shaped  
Free Standing Bathtub with built-in overflow hole.  
Rim Thickness: 30mm  
Material: Resin Transfer Moulding  
Size: 1660 x 750 x 535 mm



## LG5-004

RTM Resin Compound Oval Shaped  
Free Standing Bathtub with built-in overflow hole.  
Rim Thickness: 30mm  
Material: Resin Transfer Moulding  
Size: 1700 x 800 x 560 mm

The images above are for reference only.  
The real object should be considered as final.

# Bathtub

---



## LG5-005

RTM Resin Compound Oval Shaped  
Free Standing Bathtub with built-in overflow hole & head rest.  
Rim Thickness: 30mm  
Material: Resin Transfer Moulding  
Size: 1780 x 780 x 940 mm



## LG5-006

RTM Resin Compound Rectangular Shaped  
Free Standing Bathtub with built-in overflow hole.  
Rim Thickness: 25mm  
Material: Resin Transfer Moulding  
Size: 1600 x 750 x 530 mm



## LG5-007

RTM Resin Compound Oval Shaped  
Free Standing Bathtub with built-in overflow hole.  
Rim Thickness: 30mm  
Material: Resin Transfer Moulding  
Size: 1800 x 800 x 600 mm



## LG5-008

RTM Resin Compound Round Shaped  
Free Standing Bathtub with built-in overflow hole.  
Rim Thickness: 50mm  
Material: Resin Transfer Moulding  
Size: 1450 x 1450 x 560 mm



## LG5-009

RTM Resin Compound Rectangular Shaped  
Built-in Bathtub with overflow & waste hole.  
Rim Thickness: 8mm  
Material: Resin Transfer Moulding  
Size: 1500 x 700 x 440 mm



## CS3-HK

'Cassia' Enamelled pressed steel drop  
in type bathtub, white color  
Size: 1500 x 700 x 390 mm

The images above are for reference only. The real object should be considered as final.



## Shower Tray



### **LG8-001**

BMC high pressure moulding Rectangular shaped shower tray with centre waste hole.

Including of supporter

Material: Bulk Moulding Compound.

Size: 1600 x 700 x 60 mm



### **LG8-002**

BMC high pressure moulding Rectangular shaped shower tray with concealed waste hole.

Including of supporter

Material: Bulk Moulding Compound.

Size: 1200 x 1000 x 60 mm



### **PU 70X90 CO**

70 x 90 cm rectangular shower tray fitted for  $\psi$  90 mm syphoned waste system  
Size: 700 x 900 x 35 mm



### **PU 70X100 CO**

70 x 100 cm rectangular shower tray fitted for  $\psi$  90 mm syphoned waste system  
Size: 700 x 1000 x 35 mm

The images above are for reference only. The real object should be considered as final.

# Shower Tray

---



## **PU 70X120 CO**

70 x 120 cm rectangular shower tray fitted for  $\psi$  90 mm syphoned waste system  
Size: 700 x 1200 x 35 mm



## **PU 70X140 CO**

70 x 140 cm rectangular shower tray fitted for  $\psi$  90 mm syphoned waste system  
Size: 700 x 1400 x 35 mm



## **PU 80X80 CO**

80 cm squared shower tray fitted for  $\psi$  90 mm syphoned waste system  
Size: 800 x 800 x 35 mm



## **PU 80X100 CO**

80 x 100 cm rectangular shower tray fitted for  $\psi$  90 mm syphoned waste system  
Size: 800 x 1000 x 35 mm

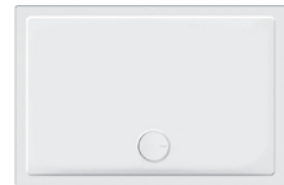

## **PU 80X120 CO**

80 x 120 cm rectangular shower tray fitted for  $\psi$  90 mm syphoned waste system  
Size: 800 x 1200 x 35 mm

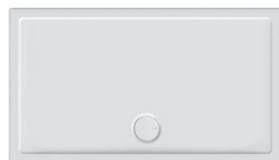

## **PU 80X140 CO**

80 x 140 cm rectangular shower tray fitted for  $\psi$  90 mm syphoned waste system  
Size: 800 x 1400 x 35 mm



## **PU 90X90 CO**

90 cm squared shower tray fitted for  $\psi$  90 mm syphoned waste system  
Size: 900 x 900 x 35 mm

The images above are for reference only. The real object should be considered as final.

# Water Closet



The images above are for reference only. The real object should be considered as final.



# Water Closet

## One-piece

## Close coupled



### NI1-002

One-piece WC, S Trap  
(250mm Roughing-in)  
Size: 670 x 360 x 800 mm



### KN1-001

Close coupled WC, S Trap  
(250mm Roughing-in)  
Size: 680 x 380 x 790 mm



### NI1-003

One-piece WC, Univeral Trap  
Size: 690 x 365 x 790 mm



### ST1-001P

Close coupled WC, P Trap  
(180mm Roughing-in)  
Size: 680 x 355 x 835 mm



### NI1-004

One-piece WC, Univeral Trap  
Size: 670 x 360 x 800 mm



### ST1-002S | ST1-002P

Close coupled WC,  
S Trap (250mm Roughing-in)  
P Trap (180mm Roughing-in)  
Size: 690 x 370 x 780 mm

The images above are for reference only. The real object should be considered as final.

# Water Closet

## Close coupled

---



### ST1-004

Close coupled WC, P Trap  
(180mm Roughing-in)  
Size: 675 x 370 x 855 mm



### ST1-007

Close coupled WC, P Trap  
(180mm Roughing-in)  
Size: 695 x 390 x 830 mm



### ST1-013S | ST1-013P

Close coupled WC,  
S Trap (250mm Roughing-in)  
P Trap (180mm Roughing-in)  
Size: 715 x 380 x 725 mm



### ST1-014S | ST1-014P

Close coupled WC,  
S Trap (250mm Roughing-in)  
P Trap (180mm Roughing-in)  
Size: 700 x 380 x 770 mm



### ST1-017S | ST1-017P

Close coupled WC,  
S Trap (250mm Roughing-in)  
P Trap (180mm Roughing-in)  
Size: 630 x 350 x 760 mm



### ST1-018S | ST1-018P

Close coupled WC,  
S Trap (250mm Roughing-in)  
P Trap (180mm Roughing-in)  
Size: 670 x 370 x 805 mm



### ST1-019P

Close coupled WC,  
P Trap (180mm Roughing-in)  
Size: 655 x 375 x 835 mm

The images above are for reference only. The real object should be considered as final.

# Water Closet

## Back-to-wall

---



### ST1-003

Back-to-wall WC, P Trap  
(180mm Roughing-in)  
Size: 590 x 350 x 470 mm



### ST1-005

Back-to-wall WC, P Trap  
(180mm Roughing-in)  
Size: 605 x 360 x 468 mm



### ST1-006

Back-to-wall WC, P Trap  
(180mm Roughing-in)  
Size: 595 x 365 x 440 mm

The images above are for reference only. The real object should be considered as final.

# Water Closet

## Wall Hung



### ST1-008

Wall Hung WC, P Trap  
(180mm Roughing-in)  
Size: 530 x 365 x 385 mm



### ST1-009

Wall Hung WC, P Trap  
(180mm Roughing-in)  
Size: 570 x 370 x 410 mm



### ST1-010-R

Wall Hung Rimless WC, P Trap  
(180mm Roughing-in)  
Size: 570 x 360 x 395 mm



### ST1-012

Wall Hung WC, P Trap  
(180mm Roughing-in)  
Size: 500 x 370 x 400 mm



### ST1-016

Wall Hung WC, P Trap  
(180mm Roughing-in)  
Size: 520 x 370 x 420 mm

The images above are for reference only. The real object should be considered as final.

# Seat and Cover

## Intelligentize

### ALB1-3650SC

Electronic bidet, with function of continuous warm water, heated seat, stainless steel nozzle, air dryer, posterior wash & automatic flushing technology

Size: 390 x 533 x 138 mm



The images above are for reference only.  
The real object should be considered as final.



## **Bidet**

---



### **ST7-001**

Vitreous china bidet, P Trap  
(180mm Roughing-in)  
Size: 550 x 340 x 400 mm



### **ST7-002**

Vitreous china bidet, P Trap  
(180mm Roughing-in)  
Size: 585 x 350 x 410 mm



### **ST7-003**

Vitreous china bidet, P Trap  
(180mm Roughing-in)  
Size: 567 x 350 x 400 mm



### **ST7-004**

Vitreous china bidet, P Trap  
(180mm Roughing-in)  
Size: 565 x 362 x 390 mm

The images above are for reference only. The real object should be considered as final.



# Urinal

## Wall Hung

## Floor Stand



### **SX3-001**

Wall Hung urinal  
Size: 460 x 350 x 750 mm



### **ST3-003T / ST3-003B**

T - Wall Hung urinal (Top Inlet)  
B - Wall Hung urinal (Back Inlet)  
Size: 340 x 300 x 690 mm



### **ST3-004**

Floor Stand urinal  
Size: 450 x 345 x 970 mm



### **ST3-005**

Wall Hung urinal  
Size: 390 x 630 x 305 mm



### **KN3-001**

Wall Hung urinal  
Size: 335 x 390 x 720 mm



### **ST3-006B**

Floor Stand urinal (Back inlet)  
Size: 445 x 380 x 990 mm

The images above are for reference only. The real object should be considered as final.



# Squatting Pan



## **ST4-001**

Squatting pan WC  
Size: 550 x 420 x 190 mm



## **SX4-001**

Squatting pan WC  
Size: 600 x 450 x 265 mm

The images above are for reference only. The real object should be considered as final.





## Cleaner Sink

Wall Hung

Pedestal



**SX5-001**

Wall Hung mop tub  
Size: 400 x 460 x 380 mm



**SX5-002**

Pedestal mop tub  
Size: 400 x 460 x 670 mm

The images above are for reference only. The real object should be considered as final.

# Baby Changing Station



The images above are for reference only. The real object should be considered as final.

# Baby Changing Station

## Vertical

---



### PM-B1

Wall mounted vertical  
baby changing station  
Size: 860 x 550 x 390 mm (Open)  
85 mm (Close)

## Horizontal

---



### PM-B2

Wall mounted horizontal  
baby changing station  
Size: 820 x 540 x 390 mm (Open)  
85 mm (Close)



### PM-B2-2

Wall mounted horizontal  
baby changing station  
with rack & tissue box  
Size: 850 x 540 x 480 mm (Open)  
78 mm (Close)



### PM-B2-3

Wall mounted horizontal  
baby changing station with tissue box  
Size: 860 x 580 x 480 mm (Open)  
78 mm (Close)

## Baby Seat

---



### PM-B3

Wall mounted baby seat  
Size: 310 x 345 x 510 mm (Open)  
140 mm (Close)

The images above are for reference only. The real object should be considered as final.

A collection of modern bathroom accessories. In the foreground, a sleek, cylindrical soap dispenser with a chrome pump mechanism sits on a white surface. To its right, a round, silver mirror is mounted on a tall, slender chrome stand with a decorative base. In the lower foreground, a rectangular, light-colored soap dish with a ribbed interior is visible. The background is softly blurred, showing a green plant and a white wall.

## Accessories

The images above are for reference only.  
The real object should be considered as final.

## Accessories

# Grab Bar

---

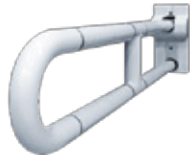

### **ATS0105/75**

Anti-bacterial ABS coated aluminium core grab bar, with Diamond pattern anti-slip textured grip finish, complies to BFA 2008  
Size: 750 x 34 dia. mm



### **AT0705/7590**

Anti-bacterial ABS coated aluminium core L-shape wall-to-wall grab bar, with Diamond pattern anti-slip textured grip finish, complies to BFA 2008  
Size: 750 x 900 x 34 dia. mm



### **AT0105/60**

Anti-bacterial ABS coated aluminium core grab bar, with Diamond pattern anti-slip textured grip finish, complies to BFA 2008  
Size: 600 x 34 dia. mm



### **AT905U2/5590**

Non conductive anti-bacterial ABS coated 1.3mm steel core surface mounted urinal grab bar with horizontal breast bar and rose flange cover, with diamond pattern and anti-slip textured grip finish  
Size: 900 x 567 x 34 dia. mm



### **GTB-32-600M**

Stainless steel grade 304 straight grab bar, with concealed rose fixing, complies to BFA 2008  
Size: 600 x 32 dia. mm

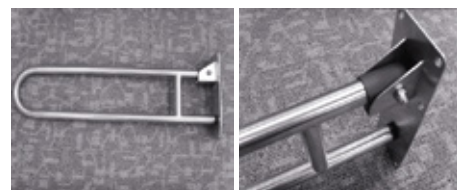

### **GTB-SU-750M**

Stainless steel grade 304 hinged support rail, with concealed rose fixing, complies to BFA 2008  
Size: 750 x 32 dia. mm

The images above are for reference only. The real object should be considered as final.

## Accessories

### Mirror

---



#### **XR0025**

Surface mounted square shaving mirror  
with LED lighting (DC) with adjustable arm set  
Size: 202 x 202 mm



#### **AT-MI-003L-SS**

Surface mounted tilting mirror,  
complies to BFA 2008  
Size: 425 x 597 x 51 mm

### Shower Seat

---

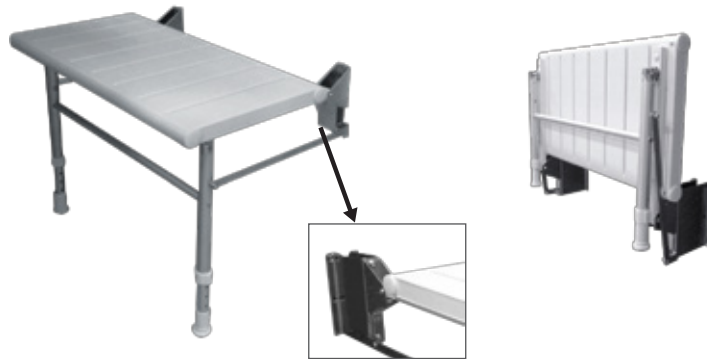

#### **AT0201WH**

Surface mounted folding type shower seat  
with water drainage slots, stainless steel support bracket, and adjustable legs  
Size: 600 x 512 mm

### Shower Curtain Rail

---



#### **SSCR-25-1500**

Stainless steel curtain rail fixing bracket  
Size: 1500 x 25 dia. mm

The images above are for reference only. The real object should be considered as final.

## Accessories

# Paper Dispenser

---



**PSD4003A**

M-fold paper towel dispenser  
Size: 260 x 90 x 180 mm



**PTD3000A**

Central fold paper towel dispenser  
Size: 250 x 230 x 210 mm



**PTD04005C**

Surface mounted jumbo roll paper holder  
Size: 390 x 130 x 370 mm



**SSA10489B**

M-fold paper towel dispenser  
Size: 283 x 100 x 365 mm



**GTB - 03A**

Stainless steel Grade 304  
surface mounted jumbo roll tissue dispenser  
with alien key lock system  
Size: 128 x 260 dia. mm

The images above are for reference only. The real object should be considered as final.

## Accessories

# Paper Holder

---



### **PU001CP**

"Pure" surface mounted paper holder  
Size: 176 x 34 x 25 mm

# Soap Dispenser

---



### **GTB-80104-230**

Chrome plated deck mounted  
230mm raised neck soap dispenser  
with plastic 470ml soap container &  
lockable cover cap  
Size: 230 x 115 mm



### **PSD08024A**

Surface mounted  
manual foam soap dispenser (400ml)  
Size: 78 x 84 x 250 mm



### **SSD-9309**

Surface mounted  
sensor liquid soap dispenser (1000ml),  
DC powered  
Size: 120 x 265 x 114 mm



### **SSD-9312D**

Surface mounted  
sensor liquid soap dispenser (1000ml),  
DC powered  
Size: 115 x 240 x 125 mm

The images above are for reference only. The real object should be considered as final.



## Accessories

### Hand Dryer



#### HDY2001-J1W

Wall mounted 1100W sensor high speed hot air hand dryer with tray & heater  
Size: 248 x 190 x 520 mm



#### HDY2001-W

Surface mounted automatic hand dryer  
Size: 248 x 178 x 250mm

### Towel Rack



#### TB0013CP

'Tube' surface mounted towel ring  
Size: 212 x 76 dia. mm



#### TB0008CP

'Tube' wall mounted 600 mm towel rack with bar  
Size: 628 x 250 x 98 mm

The images above are for reference only. The real object should be considered as final.

## Accessories

### Robe Hook

---



**3078-3**

Wall mounted robe hook with bumper  
Size: 77 x 50 dia. mm

### Brush Holder

---



**1009**

Free standing toilet brush holder  
with toilet brush and cover  
Size: 370 x 75 dia. mm

### Soap Basket

---



**OT1002**

Surface mounted soap holder  
Size: 210 x 190 x 70 mm



**3038-1**

Surface mounted soap basket  
Size: 220 x 170 x 30 mm



**113B-SS**

Surface mounted shower basket  
Size: 307 x 88 x 146 mm

The images above are for reference only. The real object should be considered as final.



┌

└

┌

└

DISCLAIMER: While every effort has been made to ensure factual accuracy, the information presented is subject to change due to requirements in different sites, markets and/or countries. PURIQUE reserves the right to make the necessary amendments at any time without prior notice.

